

Soils Map

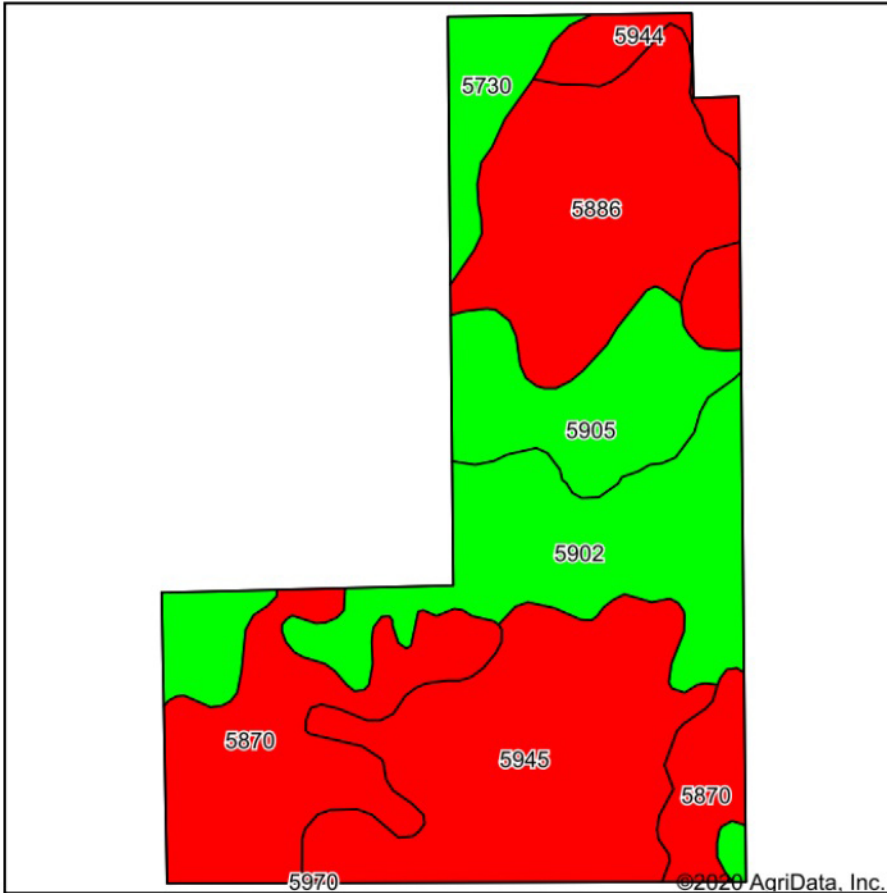

Soils data provided by USDA and NRCS.

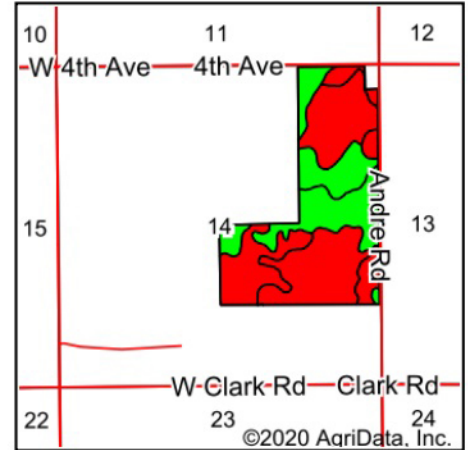

State: **Kansas**
 County: **Reno**
 Location: **14-23S-9W**
 Township: **Huntsville**
 Acres: **157.2**
 Date: **10/12/2020**



Area Symbol: KS155, Soil Area Version: 17

Code	Soil Description	Acres	Percent of field	Non-Irr Class Legend	Non-Irr Class *c	Irr Class *c	*n NCCPI Soybeans
5945	Saltcreek-Funmar-Farnum complex, 1 to 3 percent slopes	36.82	23.4%		IIe	Iw	59
5870	Carway and Carbika soils, 0 to 1 percent slopes	32.07	20.4%		IIw	IIw	53
5886	Farnum and Funmar loams, 0 to 1 percent slopes	28.75	18.3%		IIc	Is	63
5902	Hayes fine sandy loam, 1 to 5 percent slopes	27.14	17.3%		IIIe	IIIe	51
5905	Hayes-Solvay loamy fine sands, 0 to 5 percent slopes	21.39	13.6%		IIIe	IIIe	51
5730	Darlow-Elmer complex, 0 to 2 percent slopes	6.83	4.3%		IVs	IVs	35
5944	Saltcreek and Naron fine sandy loams, 1 to 3 percent slopes	4.20	2.7%		IIe	Ie	57
Weighted Average							*n 54.9